



Commercial
5 Cork Street
Frome
BA11 1BL

Rent £11,000pa
Ratable Value £8,100

A prime, centrally located shop unit. Self-contained with a front retail area, inner lobby and plenty of storage area with separate WC facilities.

Would suit a variety of uses but would be ideal as an office/retail space.

563 sqft (52.4 sqm) in total.

Available by way of new, internally fully insuring and repairing lease.

Long Lease Available

Each party is liable for their own legal fees

Ground Floor

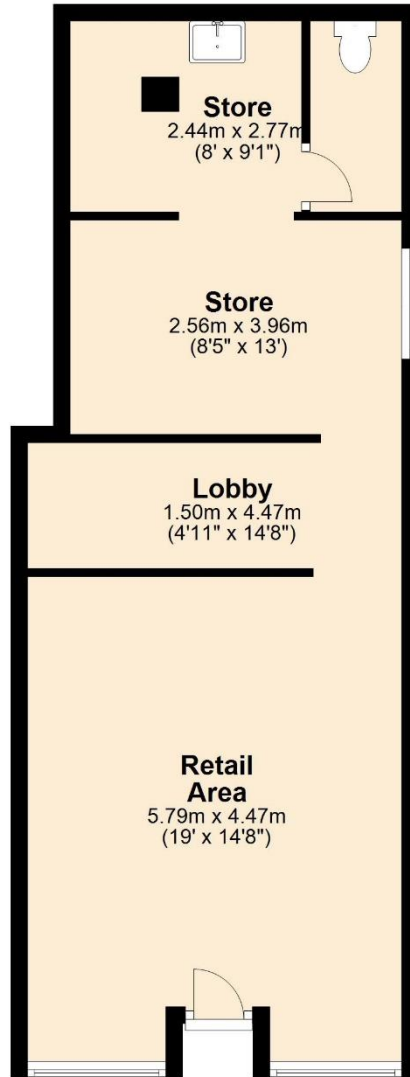

Total area: approx. 52.4 sq. metres (563.9 sq. feet)

This floor plan is a guide only
Plan produced using PlanUp.



IMPORTANT: we would like to inform prospective purchasers that these sales particulars have been prepared as a general guide only. A detailed survey has not been carried out, nor the services, appliances and fittings tested. Room sizes should not be relied upon for furnishing purposes and are approximate. If floor plans are included, they are for guidance only and illustration purposes only and may not be to scale. If there are any important matters likely to affect your decision to buy, please contact us before viewing the property.

24 Bath Street, Frome, Somerset, BA11 1DJ
T 01373 454 335
E info@rogersandcompany.co.uk
rogersandcompany.co.uk

